



GAMEDAY

FEBRUARY 18, 2022

6:00 & 7:30 pm

TICKETS \$5 at the door (cash only)



Markus Lanier
mgr.



Nick Hixson
mgr.

CONGRATULATIONS CLASS OF 2022



**EDMOND NORTH HUSKIES vs.
EDMOND SANTA FE WOLVES**



WELCOME TO THE CAMPUS OF SANTA FE HIGH SCHOOL



STATE CHAMPIONSHIPS

BASEBALL
2019

BOYS BASKETBALL
2005

GIRLS BASKETBALL
2011, 2012

CHEER
2004

POWERLIFTING
2014, 2015, 2016,
2017, 2018, 2019

BOYS SOCCER
1996, 2009

BOYS TRACK
1997, 2011

GIRLS TRACK
2012

VOLLEYBALL
1993, 1994, 1995, 2004
2013, 2017, 2018

On behalf of Edmond Santa Fe High School welcome to our jv/varsity basketball contest.

This 2021-22 Game Day Information Guide will provide important information regarding your visit to our facilities.

Please share this guide freely with all parties venturing to our site so that everyone's visit will be a smooth and positive experience.

If you have any questions or concerns or simply need additional information, please contact our athletic office at (405) 726-7305 or by email: andrew.rasmussen@edmondschools.net.

We look forward to our upcoming game(s) and wish your school good luck!

Respectfully,

A handwritten signature in black ink, appearing to read 'Andrew Rasmussen'.

Andrew Rasmussen
Director of Athletics
Edmond Santa Fe High School

GoSFWolvesAthletics.com

1901 W. 15th Street Edmond, Oklahoma 73013 405-340-2230
santafe.edmondschools.net

SANTA FE ATHLETICS



OUR VISION:

No challenge is too great when we work together as a Pack. Our Pack mentality of extreme loyalty, ownership, and devotion to our school binds us together as a unit. Ultimately, Success Brings Us Together.

MISSION OF SANTA FE ATHLETICS:

It is our mission to create an environment that encourages, motivates, and prepares student athletes to become champions in the classroom, in life, and in sport through the positive experience of competing as an athlete at Edmond Santa Fe.

Core Values:

WOLVES CARE!

COURAGE - A Wolf will lead with COURAGE to own their actions and do the right thing.

ATTITUDE - A Wolf will display a winning ATTITUDE in and out of sport.

RESPECT - A Wolf will show RESPECT for the game and all involved.

EFFORT - A Wolf will give relentless EFFORT in everything we do.

GoSFWolvesAthletics.com

1901 W. 15th Street Edmond, Oklahoma 73013 405-340-2230
santafe.edmondschools.net

GAME DAY SCHEDULE



<u>TIME OF DAY</u>	<u>EVENT</u>
3:10 pm	Ticket Booth & Gates Open (Visiting JV teams arrive and shown to locker rooms)
3:15 pm	Girls JV Teams begin warm-up
3:30 pm	Tip-off of Girls JV Game
4:45 pm	Tip-off of Boys JV Game
5:45 pm (tentative)	Girls Teams Warm-up on the floor
6:00 pm	National Anthem Introduction of both Away & Home starters
6:05 pm	Tip-off of Girls Varsity Game
7:15 pm	Boys Teams Warm-up on the floor
7:30 pm	Introduction of both Away & Home starters Tip-off of Boys Varsity Game

GoSFWolvesAthletics.com

1901 W. 15th Street Edmond, Oklahoma 73013 405-340-2230
santafe.edmondschools.net

QUARTERS & HALFTIME SCHEDULE



BEFORE THE GIRL'S VARSITY GAME:

Girls teams warm up
National Anthem

HALFTIME:

CANES 40 Second Challenge

AFTER THE GIRL'S VARSITY GAME:

Teams shake hands at division line and will return to their locker rooms. Boys teams will enter the floor from their locker rooms and begin warm up after the court clears.

SENIOR NIGHT RECOGNITION:

Boys Basketball seniors

BEFORE THE BOY'S VARSITY GAME:

Boys teams warm up

HALFTIME:

CANES 40 Second Challenge

POST GAME:

Teams shake hands at division line and will return to their locker rooms.

**** NO ONE IS ALLOWED ON THE COURT AFTER THE GAME ****

GoSFWolvesAthletics.com

**1901 W. 15th Street Edmond, Oklahoma 73013 405-340-2230
santafe.edmondschools.net**

EDMOND PUBLIC SCHOOLS DEPARTMENT OF ATHLETICS



District Director of Athletics:

Mike Nunley (405) 340-2800
mike.nunley@edmondschools.net

Site Athletic Director:

Andrew Rasmussen (405) 726-7305
andrew.rasmussen@edmondschools.net

Financial Secretary:

Shelly Gregory (405) 726-7314
shelly.gregory@edmondschools.net

Head Athletic Trainer:

D'Anna Kyle, ATC (4174) 684-0178
720-athtrain@edmondschools.net

Superintendent:

Dr. Angela Grunewald

Asst. Superintendent:

Dr. Debbie Bendick

ESFHS Principal:

Jason Hayes

Asst. Principals:

Catherine Johnston, David Gibson, Lisa Adams,
and Stephanie Hanson

GoSFWolvesAthletics.com

**1901 W. 15th Street Edmond, Oklahoma 73013 405-340-2230
santafe.edmondschools.net**

2021-2022 BASKETBALL JV/VARSITY SCHEDULE





<u>Date</u>	<u>Opponent</u>	<u>Home/Away</u>	<u>Time</u>
Dec. 3	Mustang	HOME	3:30 / 4:45 / 6:00 / 7:30
Dec. 7	Deer Creek	Away	3:30 / 4:45 / 6:00 / 7:30
Dec. 9-11	Edmond Open Tournament (Boys)	@ North HS	TBA
Dec. 9-11	Harrah Tournament (Girls)	@ Harrah HS	TBA
Dec. 14	Stillwater	Away	3:30 / 4:45 / 6:00 / 7:30
Dec. 17	Edm. Memorial (Boys Only 9, JV, V)	HOME	F 4:30 / JV 5:45 / V 7:00
Jan. 4	Moore	Away	3:30 / 4:45 / 6:00 / 7:30
Jan. 6-8	Bishop McGuinness Tournament (Boys)	@ McGuinness	TBA
Jan. 6-8	PCO Invitational Tournament (Girls)	@ PC West	TBA
Jan. 14	Norman North	HOME	3:30 / 4:45 / 6:00 / 7:30
Jan. 18	Yukon	Away	3:30 / 4:45 / 6:00 / 7:30
Jan. 20-22	Newcastle Tournament (Girls)	@ Newcastle	TBA
Jan. 20-22	Jenks Invitational (Boys)	@ Jenks/Union HS	TBA
Jan. 25	Edm. Memorial (Girls Only 9, JV, V)	HOME	F 4:30 / JV 5:45 / V 7:00
Jan. 28	Norman	HOME	3:30 / 4:45 / 6:00 / 7:30
Feb. 1	Westmoore	HOME	3:30 / 4:45 / 6:00 / 7:30
Feb. 4	Southmoore	Away	3:30 / 4:45 / 6:00 / 7:30
Feb. 8	Edmond North	Away	3:30 / 4:45 / 6:00 / 7:30
Feb. 11	Edmond Memorial	Away	3:30 / 4:45 / 6:00 / 7:30
Feb. 15	Deer Creek	HOME	3:30 / 4:45 / 6:00 / 7:30
Feb. 18	Edmond North	HOME	3:30 / 4:45 / 6:00 / 7:30
Feb. 24-26	Boys/Girls Regional Tournament	TBA	TBA
Mar. 3-5	Boys/Girls Area Tournament	TBA	TBA
Mar. 10-12	Boys/Girls State Tournament	Mabee Center (ORU), Tulsa	TBA

GoSFWolvesAthletics.com

**1901 W. 15th Street Edmond, Oklahoma 73013 405-340-2230
santafe.edmondschools.net**

SANTA FE BASKETBALL COACHES INFORMATION



	CASI BAYS <i>HEAD GIRL'S COACH</i> <i>2ND YEAR</i>	MICHELLE HAZELIP <i>ASSISTANT VARSITY COACH</i>
		BEN SMITH <i>ASSISTANT VARSITY COACH</i>
		BLESSING PLUMP <i>HEAD FRESHMAN COACH</i> <i>ASSISTANT VARSITY COACH</i>
	TROY LALLEMAND <i>HEAD BOY'S COACH</i> <i>3RD YEAR</i>	TIM FLANIGAN <i>ASSISTANT VARSITY COACH</i>
		DJ LEMMONS <i>ASSISTANT VARSITY COACH</i>
		RICKY VICK <i>HEAD FRESHMAN COACH</i> <i>ASSISTANT VARSITY COACH</i>

GoSFWolvesAthletics.com

1901 W. 15th Street Edmond, Oklahoma 73013 405-340-2230
santafe.edmondschools.net

SANTA FE GIRLS PLAYER INFORMATION



#	Name	Class	Position	Height	Pronunciation
1	Diamond Britt	Fr.	G	5' 8"	Diamond Britt
2	Nailayn Griffin	Sr.	G	5' 6"	Neigh-lon Griffin
3	Amaya Grissom	So.	G	5' 7"	Uhmaya Griss-um
5	Lydia Hall	Fr.	G	5' 8"	Lid-ee-uh Hall
10	Aniyah Burney	Fr.	G	5' 9"	Uh-nigh-yuh Burn-ee
12	Gracie Taft	Sr.	G	5' 7"	Gracie Taft
14	Brooke Robertson	Sr.	G	5' 8"	Brook Robertson
15	Willa Ford	So.	G	5' 7"	Will-uh Ford
20	Maggie Rasmussen	Sr.	F	5' 9"	Maggie Ras-muss-in
21	Jerney Bennett	So.	F	6' 1"	Journey Bennett
22	Sarah Gorman	Jr.	F	6' 1"	Sarah Gore-man
23	Devyn Woods	Sr.	G	5' 6"	Dev-in Woods
32	Taryn Crawford	Jr	F	5' 10"	Tear-in Crawford
33	Peyton Best	Fr.	C	6' 0"	Peyton Best
43	Laiyanna Jethrow	So.	F	5' 11"	Lay-anna Jethrow

HEAD COACH: Casi Bays

ASST. COACHES: Michelle Hazelip, Ben Smith, and Blessing Plump

GoSFWolvesAthletics.com

1901 W. 15th Street Edmond, Oklahoma 73013 405-340-2230
santafe.edmondschools.net

SANTA FE BOYS PLAYER INFORMATION



1	Tanner Williams	Sr.	G	6'1"	Tanner Williams
2	Niko Cooper	Jr.	G	5'7"	Knee-Co Cooper
3	Kaysen Gipson	Jr	G	5'7"	Kaysen Gipson
4	Aidan Vaughn	Sr.	G	5'8"	A-den Vaughn
5	Joe Adams	Sr.	F	6'1"	Joe Adams
10	Morgan Lane	Jr.	G	5'8"	Morgan Lane
11	Bergin Kysar	So.	C	6'4"	Berg-in Ky-ser
12	Jayden Cincotta	Jr.	SG	6'1"	Jay-Dun Sin-cot-ta
13	Nik Rhodes	So.	SG	5'6"	Nick Roads
15	Trey Morgan	Jr.	G	5'9"	Trey Morgan
20	Jantz Alsup	Fr.	C	6'3"	Jants Alsup
21	Drelen Nero	So.	F	6'2"	Dre-Lynn Near-O
22	Mason Lee	Sr.	PG	5'7"	Mason Lee
23	Keith Jakes	Jr.	F	6'2"	Keith Jakes
24	Michael Reeves	Sr.	PG	5'10"	Michael Reeves
25	Mario Ramsey	Jr.	G	5'6"	Mario Ramsey
32	Tristan Peters	Jr.	C	6'2"	Tristan Peters

Head Coach: Troy Lallemand

Asst Coaches: DJ Lemons, Tim Flanigan, Rickey Vick

Managers: Nayeli Ponce, Kenzie Session, Nick Hixson, Markus Lanier

Athletic Trainer: D'Anna Kyle

Athletic Director: Andy Rasmussen

GoSFWolvesAthletics.com

1901 W. 15th Street Edmond, Oklahoma 73013 405-340-2230
santafe.edmondschools.net

EDMOND NORTH GIRLS PLAYER INFORMATION



Name	#	Position	Height	Grade
Casaus, Ataya	0	Guard	5'6	12
Papahronis, Elle	4	Guard/Forward	5'11	11
Peeler, KK	5	Guard	5'3	10
Jackson, Mallory	10	Forward	5'10	10
Harmon, Abigail	11	Guard	5'3	12
Fisher, Riley	12	Guard	5'5	10
Heathcock, Allison	13	Guard	5'11	10
Noller, Kate	21	Guard	5'7	9
Papahronis, Toni	22	Guard	6'0	12
Melton, Kate	23	Guard	5'7	10
Steele, Laci	24	Guard/Forward	5'10	11
Franklin, Ryan	32	Center	6'3	12

Papahronis, Pete	Head Coach
McIntosh, Allison	Asst. Coach
Parker, Sarah	Asst. Coach
Hock, Jeff	Asst. Coach

GoSFWolvesAthletics.com

**1901 W. 15th Street Edmond, Oklahoma 73013 405-340-2230
santafe.edmondschools.net**

EDMOND NORTH BOYS PLAYER INFORMATION



#0	Bryson Buckingham	5-11	Sophomore
#1	Tatum Ridge	6-0	Sophomore
#2	TO Barrett	6-3	Sophomore
#3	Cahlese Lee	6-2	Senior
#4	Landin Fitzgerald	5-8	Sophomore
#10	Cole Greene	5-10	Senior
#11	Niko Papasasantou	6-3	Junior
#12	Mikah Branson	6-3	Senior
#15	Connor Mills	5-10	Junior
#22	Ethan Brady	6-4	Junior
#23	Dylan Warlick	6-5	Sophomore
#30	TJ Strong	6-7	Junior
#32	Bryce Potts	6-6	Sophomore
#34	Xavier Ross	6-7	Sophomore
#42	Logan Knoll	6-4	Freshman

Head Coach: Scott Norris
Assistant Coaches: Corbin Byford, Brandon Mitchell, Justin Smart
Student Manager: Spencer Windholz

Athletic Trainer: Scott Delcamp
Athletic Director: Baron Potter

GoSFWolvesAthletics.com

1901 W. 15th Street Edmond, Oklahoma 73013 405-340-2230
santafe.edmondschools.net

SANTA FE GYM

GENERAL INFORMATION



Team Nickname	Wolves
Team Colors	Hunter Green & Gray (Hunter Green for Home Games)
Game Times	JV Girls @ 3:30; JV Boys @ 4:45; Varsity Girls @ 6:00, Varsity Boys @ 7:30
Game Site	Santa Fe High School 1901 West 15th Street, Edmond, OK 73013
Visiting Team	GIRLS: Volleyball Locker room; BOYS: Freshman Boys Locker room
Band, POM PONS, Cheerleaders	Will be admitted free if in uniform (Band limited to two directors and two sponsors)
Halftime	Length will be according to OSSAA policies/guidelines
ADMISSION	General Admission \$5.00
FACULTY MEMBERS	Teachers from COAC Conference schools will be admitted free with faculty pass (<u>faculty pass does not admit family members</u>)
PASSES HONORED	Oklahoma Coaches Association, OSSAA (OEA passes <u>will not</u> be honored)
VISITING SCHOOL	Team bench located on the Left Side of the scorer's table
SEATING ARRANGEMENTS	Visitors -- South side bleachers (behind the scorer's table) upper level of gym. Parking is available North of the Main Gym.
VISITING FILMER	Film from designated filming area located in the visitor's section in the upper seating area of the Main Gym.
TV & RADIO	Arrangements must be made with Mike Nunley, District Athletic Director @ 405-340-2842. Live, taped, or delayed - \$250 for Radio and \$300 for TV

GoSFWolvesAthletics.com

1901 W. 15th Street Edmond, Oklahoma 73013 405-340-2230
santafe.edmondschools.net

PARKING

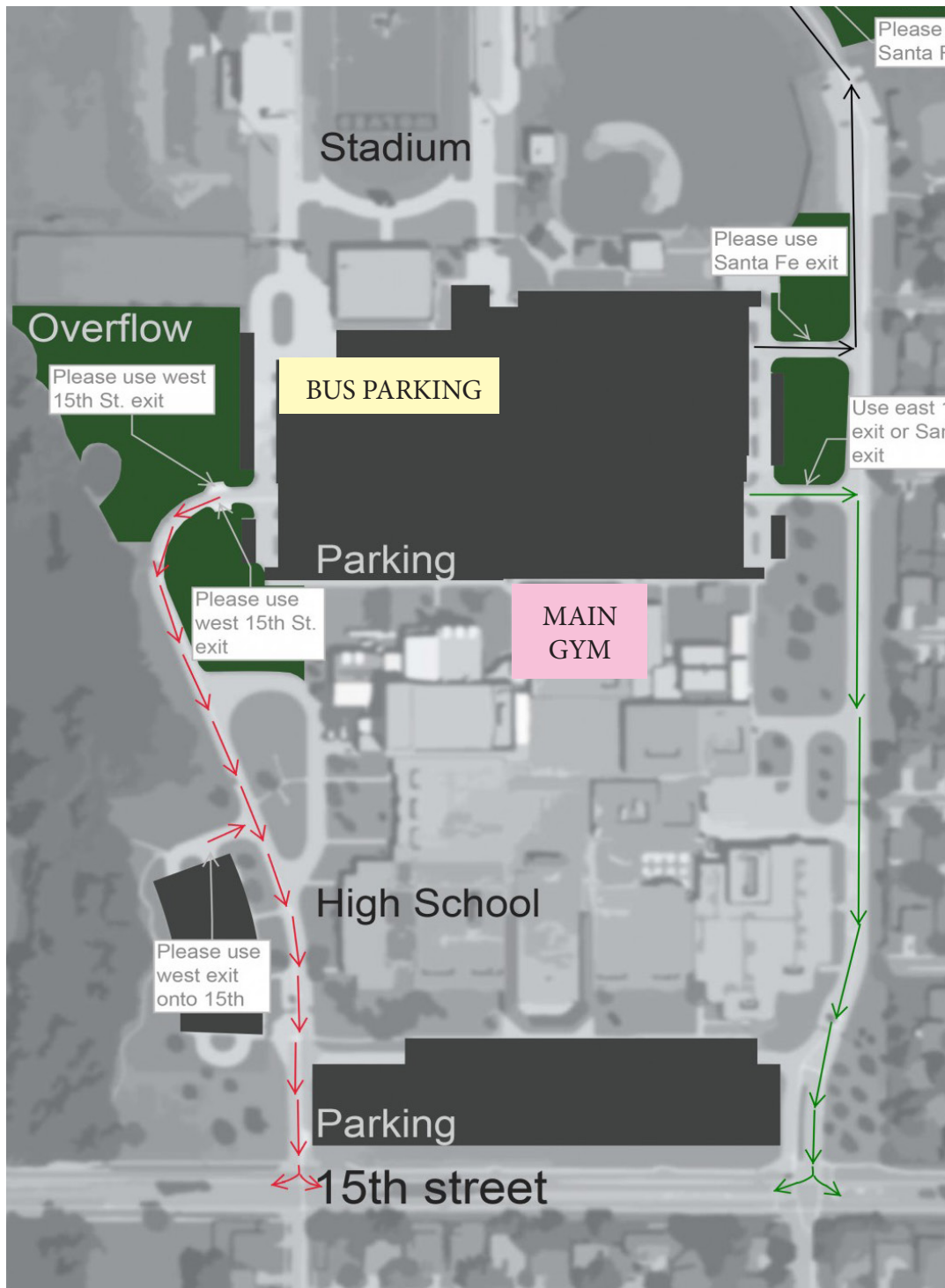

GoSFWolvesAthletics.com

1901 W. 15th Street Edmond, Oklahoma 73013 405-340-2230
santafe.edmondschools.net

VISITING TEAM INFORMATION

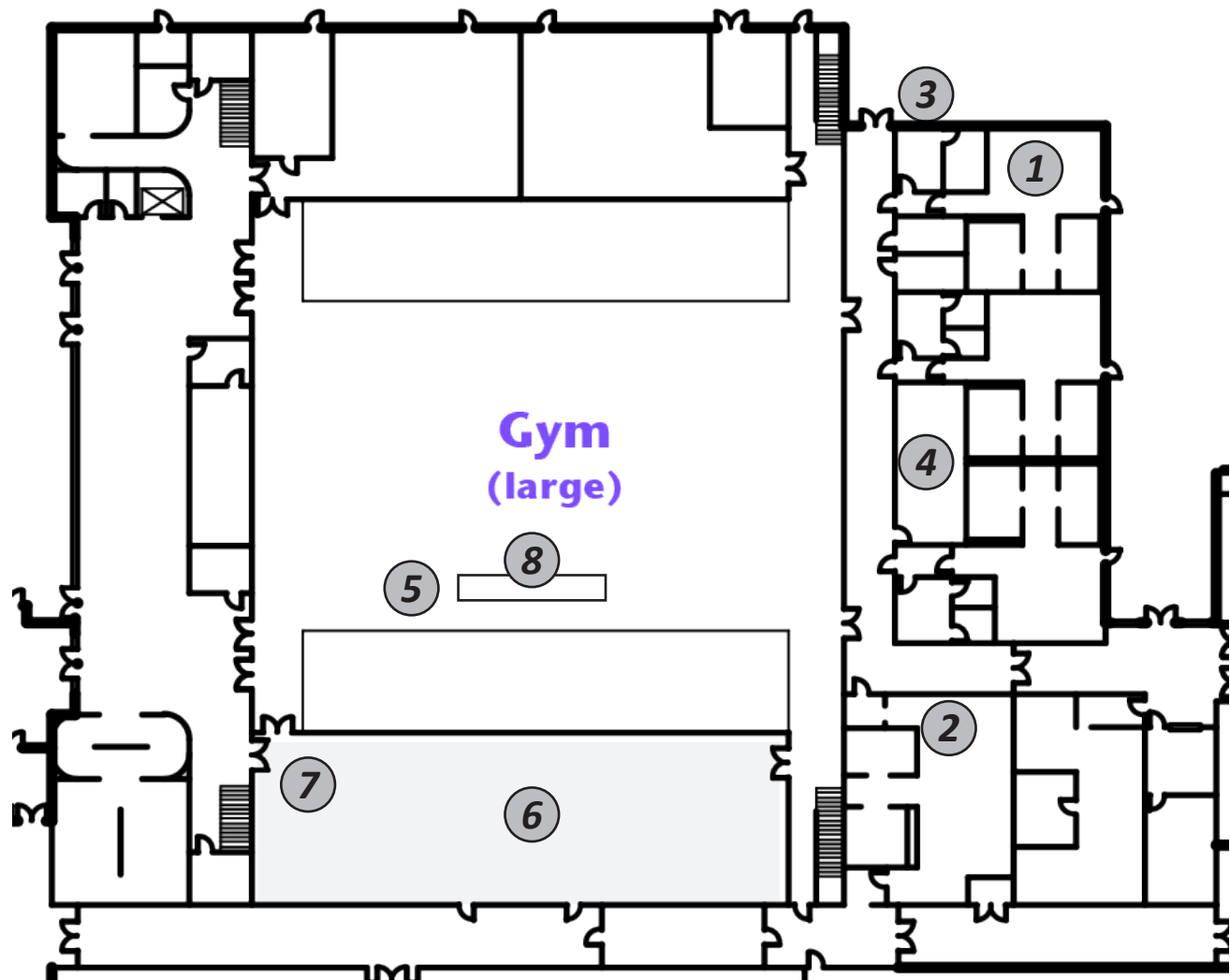

- | | |
|------------------------------|---|
| 1. Visitor Boys Locker room | 6. Visitor's Camera/Film area (upper level) |
| 2. Visitor Girls Locker room | 7. Visitor's spectator seating (upper level only) |
| 3. Officials' Changing room | 8. Score table |
| 4. Trainer's Room | |
| 5. Visitor bench seating | |

GoSFWolvesAthletics.com

1901 W. 15th Street Edmond, Oklahoma 73013 405-340-2230
santafe.edmondschools.net

GYM SEATING INFORMATION



**** Coaches, please share this information with your players and fans prior to coming to our event.**

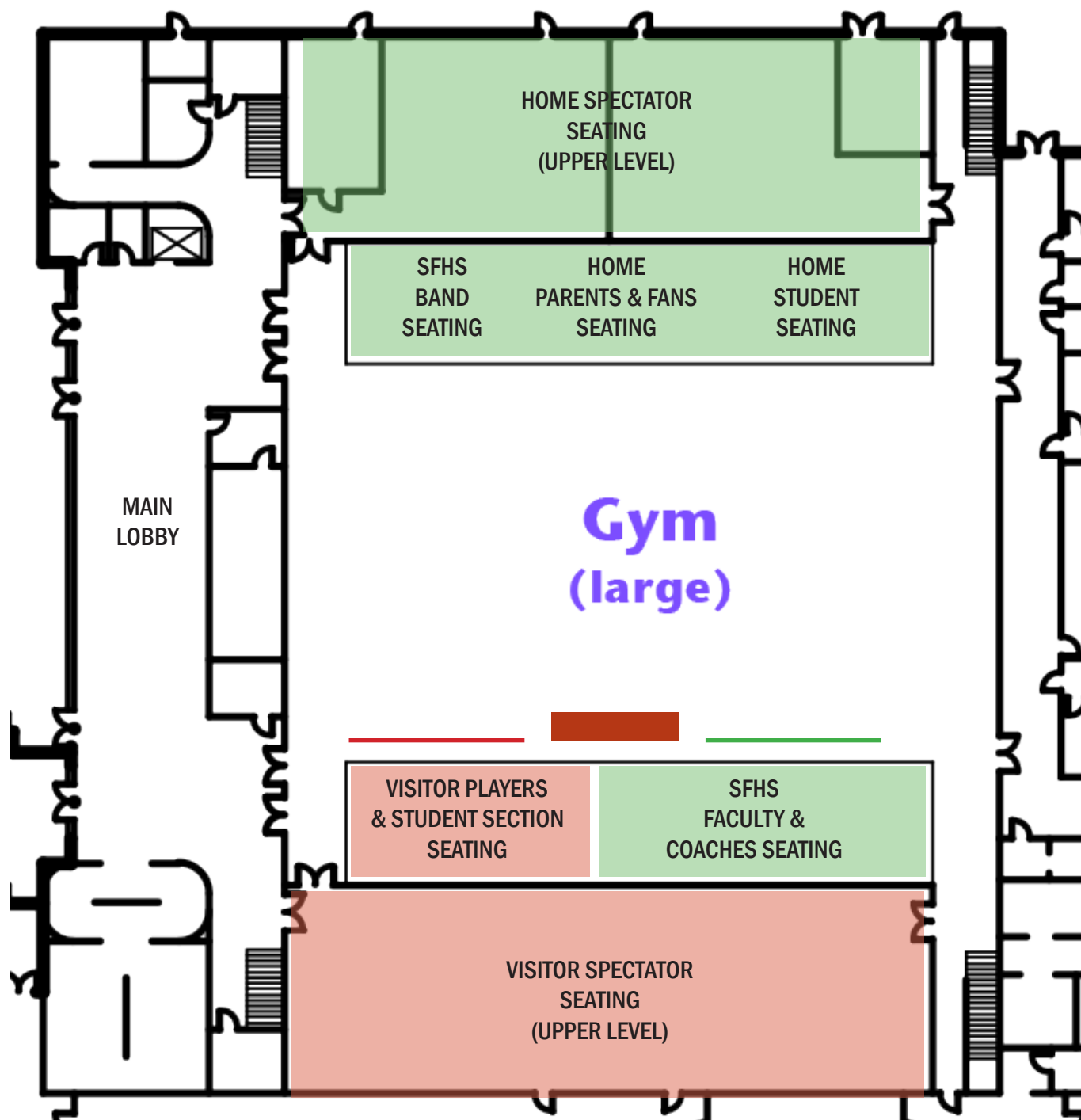

GoSFWolvesAthletics.com

1901 W. 15th Street Edmond, Oklahoma 73013 405-340-2230
santafe.edmondschools.net

WOLVES AT THE 'NEXT LEVEL'



BOYS BASKETBALL

Todd Siebert (NOC Tonkawa)
Isaac Robinson (Rose State)
Brian Roland (UCO)
DeAngelo Garrett (NOC Tonkawa)
Johnnie Young (Southern Univ)
JM Palovik (MidAmerica Christ.)
Brandy Mayes (Seminole)
Obi Muonelo (Ok State)
Ekpe Udoh (Michigan/Baylor)
Drew Haymaker (Central Ark.)
Andy Shaw (Ok State)
Chance Hardaker (UCO)
Carlton Dean (Jarvis Christian)
Joey Atkinson (Langston)
Javvero Baker (UCO)
Kevin Blackmon (Hesston Coll)
Cyriacus Igilo (Jarvis Christian)
Ricky Vick (Fresno Pacific)
Ross Morrisett (NOC/OC)
Nic Combs (Troy/UCO)
Victor Driver (UCO)
Mahlon Jones (Hesston/UCO)
Jordan Murrell (Seminole St.)
Chris Jones (Central Christ., KS)
Orion Palmer (Lipscomb Univ)
Chad Johnson (Lipscomb Univ)
Josh Richardson (Tennessee)
Phoenix Bills (St. Gregory's)
Aaron Anderson (Fresno St/ORU)
Justin Jones (Peru State Univ)
Dashon Bell (Fredrick/UCO)
DaQuan Jeffries (ORU/Tulsa)
Daron Mims (Allen/Angelo St.)
Conner Johnson (OC)
James Bagwell (OC)
Tyler Williams (Allen Co/Ark Ft-S)
DeAngelo Adkins (Seminole St.)
Jeremy Mays (Southwestern CC)
Tauriawn Knight (Utah St.)
Kamden Gipson (SWOSU)
Tyus Jeffries (Allen County)
Jaylen O'Conner (Nat. Park Coll)
Ben Smith (SWOSU)
Donovan Vickers (So. Ark. Univ)
Jvon Huthinson (Cent. Baptist)
Kristian Baccus (Langston)



EKPE UDOH (Golden State/Milwaukee/Utah/
Overseas...Beijing/Bologna)



JOSH RICHARDSON (Miami/Phil./Dallas/
Boston)



DAQUAN JEFFRIES (Sacramento/Houston/
San Antonio)

GIRLS BASKETBALL

Sheri McNiven (OC)
Shannon Mayberry (Pepperdine Univ)
Debreon Davis (Evangel)
Alex Richardson (Ok State/UCO)
Christina Yarborough (UCO)
Blessing Uba (Savannah St)
Jimmy Blagowsky (USAF Academy)
Daisha Gonzaque (OC)
Jazmine Hinton (OC)
Courtney Walker (Texas A&M)
Taylor Nashert
Arielle Cooper (Redlands/OBU)
Sara Vargas
Rachel Shadid (OBU)
Cameerah Graves (OBU)
Mariah Williams (Redlands)
Tamara Lee (Univ. of Denver/Indiana St.)
Summer Jones (Seminole/U. of Nrt. Tx)
Amanda Allen
Jo'nah Johnson (UCO/Texas Tech)
Euresia Brown
Abigail Olsen
Andrea (Dre) Cooper (Providence)
Mariah Jones (Redlands)
Maikayla Chambers
Jasmine Taplin
RaVon Nero (Butler CC/Kan. City Col)
Keira Neal (Univ. of North Tx)
Kryslyn Jones (Seminole/TA&M Kingsville)
Ahoneste Walker
Kaylee Nero
Kashell Daughty (Western Ok State)
Brooklyn Long (OC)