

SANTA FE WRESTLING



2023 - 2024

# GAMEDAY

VISITORS GUIDE





# Welcome to Edmond Santa Fe!

## STATE CHAMPIONSHIPS

BASEBALL  
2019

BOYS BASKETBALL  
2005

GIRLS BASKETBALL  
2011, 2012

CHEER  
2004

POWERLIFTING  
2014, 2015, 2016,  
2017, 2018, 2019,  
2022

BOYS SOCCER  
1996, 2009

BOYS TRACK  
1997, 2011

GIRLS TRACK  
2012  
2023 4x200m  
National Champions

VOLLEYBALL  
1993, 1994, 1995, 2004  
2013, 2017, 2018

On behalf of Edmond Santa Fe High School welcome to today's wrestling event.

This Game Day Information Guide will provide important information regarding your visit to our facilities.

Please share this guide freely with all parties venturing to our location so that everyone's visit will be a smooth and positive experience.

If you have any questions or concerns or simply need additional information, please contact our athletic office at (405) 726-7305 or by email:  
[andrew.rasmussen@edmondschools.net](mailto:andrew.rasmussen@edmondschools.net).

We look forward to our upcoming game(s) and wish your school good luck!

Respectfully,

Director of Athletics  
Edmond Santa Fe High School





## Visiting Team Information

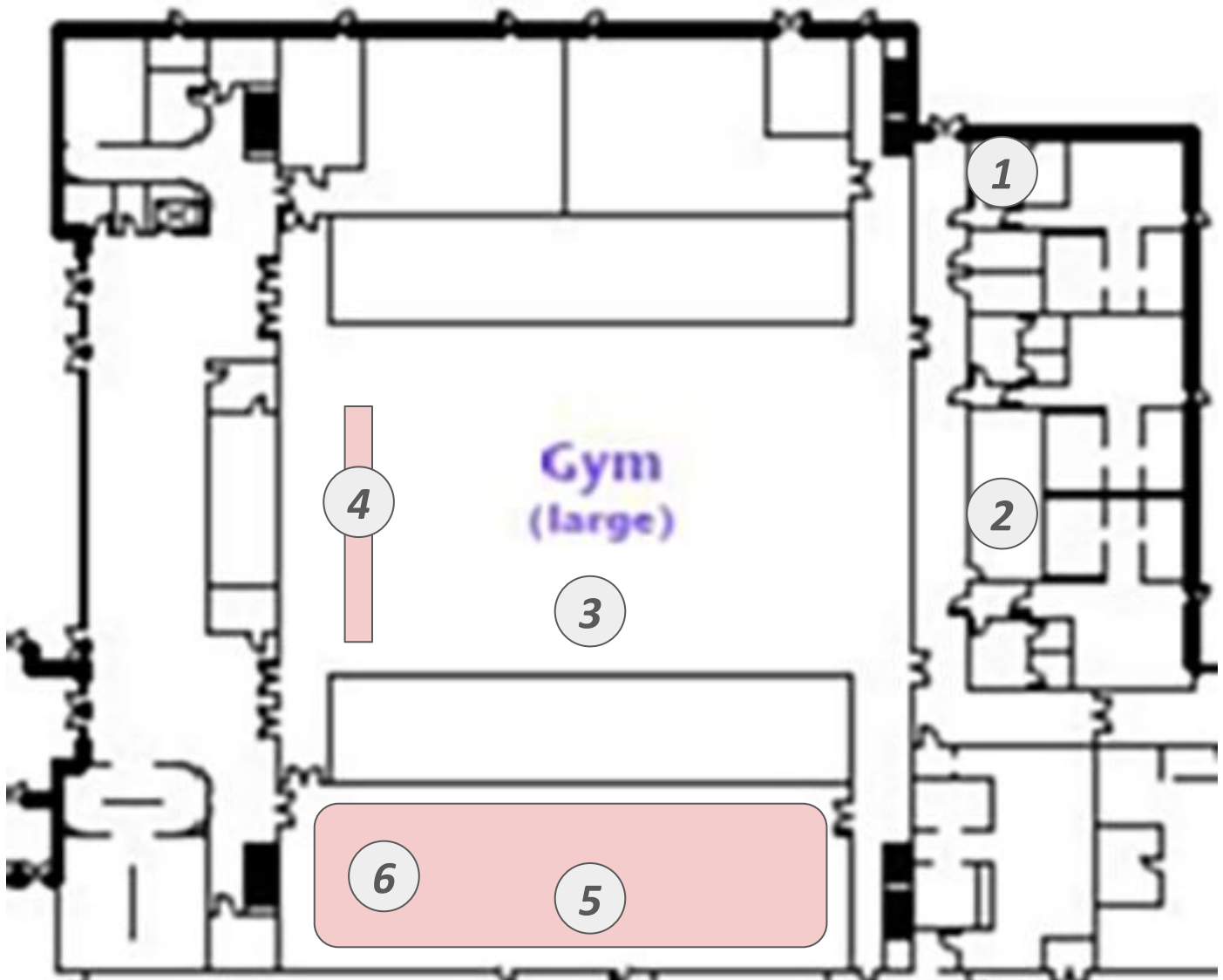

- |     |                          |    |                                                   |
|-----|--------------------------|----|---------------------------------------------------|
| 1.  | Officials' Changing room | 5. | Visitor's Camera/Film area<br>(upper level)       |
| 2.  | Trainer's Room           | 6. | Visitor's spectator seating<br>(upper level only) |
| 3.  | Score table              |    |                                                   |
| 4.. | Visitor bench seating    |    |                                                   |





# Santa Fe Wrestling Player Information



## **SANTA FE WRESTLING** **STARTING LINEUP**

### ***BOYS HIGH SCHOOL WRESTLERS***

<b>106</b>	<b>COLLIN DOLEAZAL</b> FRESHMAN	<b>120</b>	<b>COLE DELGADO</b> FRESHMAN
<b>126</b>	<b>GAVIN HORN</b> SENIOR	<b>138</b>	<b>NICK PAVON</b> SOPHOMORE
<b>144</b>	<b>TREY ROBINSON</b> FRESHMAN	<b>150</b>	<b>BREYLAN DIAZ</b> JUNIOR
<b>165</b>	<b>BROCK BALLESTEROS</b> SOPHOMORE	<b>175</b>	<b>HUNTER SCHEIHING</b> SOPHOMORE
<b>215</b>	<b>LUKE COMPTON</b> SOPHOMORE	<b>285</b>	<b>NOAH COMPTON</b> SENIOR
<b>OPEN</b>	<b>113, 132, 157, 190</b>		

### ***LADY HIGH SCHOOL WRESTLERS***

<b>KIMBERLY HERNANDEZ (FR)</b>
<b>MICHA LAMERE (JR)</b>
<b>CARISSA WRIGHT (SO)</b>

# Sporting Event Regulations



## H I G H S C H O O L SPORTING EVENT REGULATIONS

All Students Must  
Wear ID & Lanyard



No Bags Permitted  
(with the exception of a  
small clutch, 4 ½ x 6 ½,  
medical or diaper bags)



No Athletic Equipment  
(Football, Basketballs, etc.)



Elementary And  
Middle School  
Students Must Be  
Accompanied By  
An Adult



Students  
From Other  
High Schools  
Must Be  
Accompanied  
By An Adult

Stay In Designated  
Cheering Sections





*GET YOUR*  
**TICKETS  
ONLINE**

**SCAN QR CODE**

**TO PURCHASE  
TICKETS NOW**



OR DOWNLOAD THE

**HOMETOWN FAN APP**







## Livestream Information



EDMOND SANTA FE ATHLETICS



# LIVESTREAM

<https://krefsports.tv/edmond/sfwolves/>





## Game Day Schedule

<b>3:15</b>	<b>Gates open</b>
	Cash only or use the QR Code to purchase online tickets. <a href="https://www.gosfwolvesathletics.com/HTtickets">https://www.gosfwolvesathletics.com/HTtickets</a> 
<b>3:30</b>	<b>Weigh-ins</b>
<b>Start time 4:00 pm</b>	<b>First dual begins Enid vs. Southmoore</b>
<b>Start time ~5:30 pm</b>	<b>Second dual begins Enid vs. Santa Fe</b>
<b>Start time ~7:00 pm</b>	<b>Final dual begins Southmoore vs. Santa Fe</b>



# Santa Fe Wrestling Coaches



**Tim Draper** Head Coach - 16th year

Head coach Tim Draper is in his 16th year at the helm of the Santa Fe Wrestling program. Before coming to Santa Fe, Draper was a teacher and wrestling coach Deer Creek (Edmond) system. He has also been an active participant and promoter in the starting of the girls wrestling program at Santa Fe-and has seen it grow in the last several year.

In 2022-23, Draper was selected as the head coach for the All-State West Wrestling team, which took place the last week in July 2023.

His son, Cade, was a 4-year wrestler at Deer Creek High School (2009) where he was a 2-time state champion at the 4A and 5A level. He then went on to wrestle at Oklahoma State University.



**Isaac Henry** - Assistant coach

Coach Henry has been with the Wrestling program since he came to Edmond Santa Fe in 2018. Henry was a part-time assistant for 2 years, before taking a full-time job with the program. He was the head coach over the Junior High program and continues to work with the JH wrestlers as well as with the high school athletes.

Henry is a 2008 Graduate of Edmond Santa Fe high school where he also wrestled for 4 years.



**Hunter Muskrat** - Assistant coach

Coach Muskrat should be a familiar name around the mat in the Edmond area. Muskrat is a graduate of Deer Creek HS (2010) and was a 4-year wrestler for Oklahoma City Univ. He was a state runner-up at 145 as a senior, and was a state champion at 140 as a junior. He was on the Oklahoma Coaches Association All-State roster for soccer his senior year.

Muskrat has been an active member in the Oklahoma Wrestling community.



# 2023-2024 Schedule

Updated 9/6/2023

DATE	DAY	OPPONENT	SITE	TIME
Nov 11	Sat	Pre-Season Yukon Tournament (HS / JH)	Away-Yukon	8:00am
Nov 18	Sat	Pre-Season Southmoore Tournament (HS/JH)	Away	8:00am
Nov 22	Wed	Pre-Turkey Tournament (HS / JH)	Away - EMHS	8:00am
Dec 5	Tue	Putnam City Dual (HS/JH)	Away	6:00pm
Dec 8 - 9	Fri - Sat	MAN Tournament (HS)	Enid	TBD
Dec 14	Thu	Tri-Dual w/Smoore and Enid (HS/JH)	Home	4:00pm
Dec 16	Sat	Norman Pool Tournament (HS)	Away	8:00am
Jan 5	Fri	Riley Andrews JH JV Tournament (JH)	Home	8:00am
Jan 6	Sat	Wolves Dual Tournament (HS)	Home	8:00am
Jan 9	Tue	Putnam City North Dual (HS/JH)	Away	6:00pm
Jan 11	Thu	Deer Creek Dual (HS / JH)	Home	6:00pm
Jan 12 - 13	Fri - Sat	COAC Tournament (HS)	Away - Smoore	TBD
Jan 15	Mon	JV 3-Dog Night (HS/JH)	Away - North	TBD
Jan 18	Thu	District Duals (Bixby, Bartlesville, Ponca City, SF) (HS/JH)	Away-Bixby	3:00pm
Jan 19 - 20	Fri - Sat	Yukon Tournament (HS)	Away	TBD
Jan 23	Tue	3-Dog Night Duals (HS/JH)	Away - North	TBD
Jan 25	Thu	Tri-Dual w/Bish McGuinness / US Grant (HS)	Home	3:00pm
Jan 26 - 27	Fri - Sat	Chickasha Tournament (HS- JV)	Away	8:00am
Jan 30	Tue	Moore Dual (HS / JH)	Away	6:00pm
Feb 9 - 10	Fri - Sat	Dual State	TBD	TBD
Feb 13	Tue	Girls Regionals	TBD	TBD
Feb 16 - 17	Fri - Sat	6A Regional	TBD	TBD
Feb 23 - 24	Fri - Sat	State	OKC Fairgrds	TBD

<b>Athletic Coordinator:</b>	Andy Rasmussen	Santa Fe:	340-2230
<b>Coaches:</b>	HS Head Tim Draper	Santa Fe:	340-2230
	HS Asst. Issac Henry		
	JH Head TBD		
	JH Asst. Hunter Muscrat		

This schedule has been approved for the above changes in red !!!





## OUR VISION:

No challenge is too great when we work together as a Pack. Our Pack mentality of extreme loyalty, ownership, and devotion to our school binds us together as a unit. Ultimately, Success Brings Us Together.

## MISSION OF SANTA FE ATHLETICS:

It is our mission to create an environment that encourages, motivates, and prepares student athletes to become champions in the classroom, in life, and in sport through the positive experience of competing as an athlete at Edmond Santa Fe.

## Core Values:

### WOLVES CARE!

**COURAGE** - A Wolf will lead with COURAGE to own their actions and do the right thing.

**ATTITUDE** - A Wolf will display a winning ATTITUDE in and out of sport.

**RESPECT** - A Wolf will show RESPECT for the game and all involved.

**EFFORT** - A Wolf will give relentless EFFORT in everything we do.



# School General Information

<b>Team Nickname</b>	Wolves
<b>Team Colors</b>	Hunter Green & Gray (Hunter Green for Home Games)
<b>Game Times</b>	Junior Varsity 5:00 pm / 6:00 pm Varsity (unless otherwise noted)
<b>Game Site</b>	Edmond Santa Fe High School 1901 West 15th Street, Edmond, OK 73013
<b>Visiting Team</b>	GIRLS: Girls PE locker room; BOYS: Boys PE locker room
<b>Band, POM, Cheerleaders</b>	Will be admitted free if in uniform (Band limited to 2 directors and 2 sponsors)
<b>Halftime</b>	Length will be according to OSSAA policies/guidelines
<b>ADMISSION</b>	General Admission \$5.00 Students from EPS and visiting team will only be allowed to purchase a cash ticket with a valid student ID. Otherwise, an online ticket will need to be purchased (see info on the next page).
<b>FACULTY MEMBERS</b>	Teachers from COAC Conference schools will be admitted free with faculty pass. <u>(A faculty pass does not admit family members!)</u>
<b>PASSES HONORED</b>	Oklahoma Coaches Association (OCA), OSSAA (OEA passes <u>will not</u> be honored), EPS Elite pass, EPS Digital Faculty pass, Student pass, Adult pass, Multi-sport discount pass
<b>VISITING SCHOOL</b>	Team bench is located on the <b>LEFT SIDE</b> of the scorer's table.
<b>SEATING</b>	Visitors -- South side bleachers (behind the scorer's table) in the upper level of the gym.
<b>PARKING</b>	Parking is available North of the Main Gym.
<b>VISITING FILMER</b>	Film from designated filming area located in the visitor's section in the upper seating area of the Main Gym.
<b>TV &amp; RADIO</b>	Arrangements must be made with Andy Rasmussen, site Athletic Director @ 405-726-7305. LIVESTREAM of the game is available through KREF. You can visit the following website to watch ESF Home games: <a href="https://krefsports.tv/edmond/sfwolves/">https://krefsports.tv/edmond/sfwolves/</a>



# EPS Department of Athletics

**District Director of Athletics:** Mike Nunley (405) 340-2800  
mike.nunley@edmondschools.net

**Site Athletic Director:** Andrew Rasmussen (405) 726-7305  
andrew.rasmussen@edmondschools.net

**Financial Secretary:** Shelly Gregory (405) 726-7314  
shelly.gregory@edmondschools.net

**Head Athletic Trainer:** D'Anna Kyle (417) 684-0178  
720-athtrain@edmondschools.net

**Superintendent:** Dr. Angela Grunewald

**Asst. Superintendent:** Debreon Davis

**ESFHS Principal:** Jason Hayes

**Asst. Principals:** Catherine Johnston, David Gibson, Lisa Adams, & Stephanie Hanson

